

Site Wide, Section D2 Rosemount Green, Facing South 1-200A
1 : 200

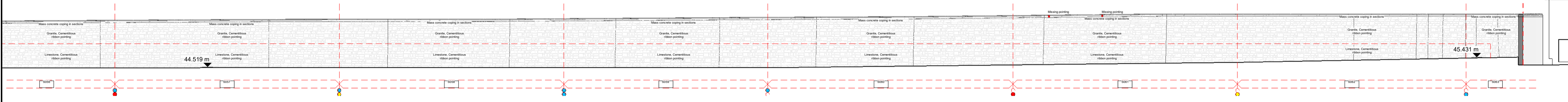

Site Wide, Section D2 Rosemount Green, Facing South 1-200B
1 : 200

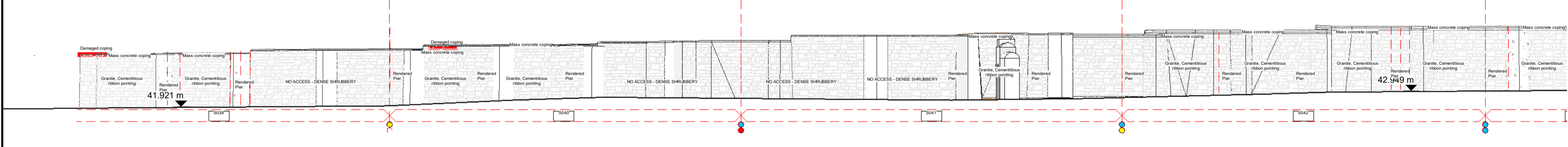

Site Wide, Section E2 Walled Garden, Facing East 1-200A
1 : 200

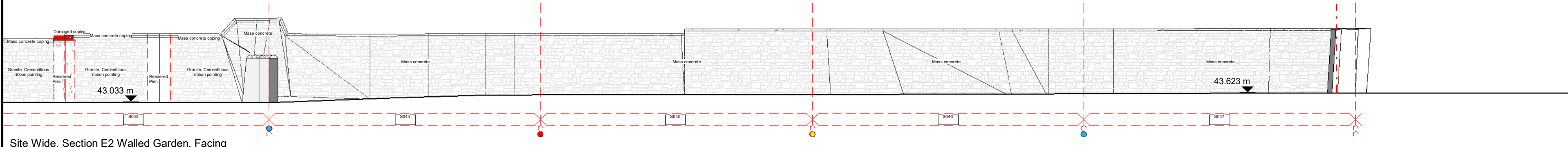

Site Wide, Section E2 Walled Garden, Facing East 1-200B
1 : 200

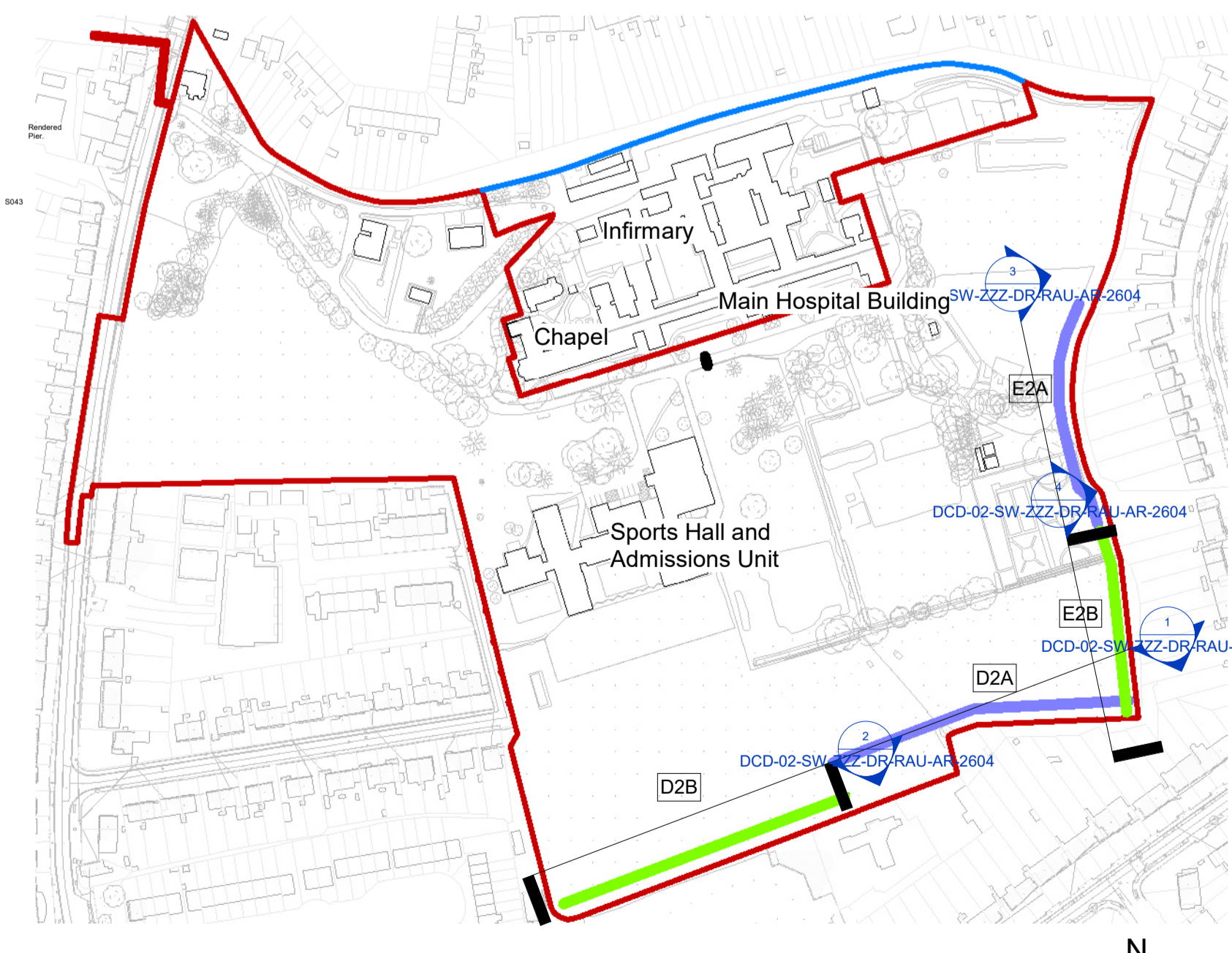

Site Plan - Existing Key Plan (Boundary Wall Survey Elevations 04)
1 : 2500

Notes:
 - Do not scale from this drawing. Use figured dimensions in all cases.
 - Verify dimensions on site and report any discrepancies to the Architect immediately.
 - This drawing is to be read in conjunction with the Architect's Specification.
 - © This drawing is copyright and may only be reproduced with the Architect's permission.

Drawing Notes:

P3 S-1	Sept 2024	KP	Part 10 Planning Application
Rev.	Date	Drawn	Details of Issue / Revision

Issues & Revisions

reddy architecture +urbanism

Dartly Mills,
Dartly Road
Dublin 6,
D06 Y0E3

T: +353 (0)1 498 7000
W: www.reddyarchitecture.com
E: info@reddyarchitecture.com

Applicant Details:
Dún Laoghaire-Rathdown County Council

Agent Details:
Land Development Agency

Project Details:
**Proposed Part 10 Residential Development,
 Dundrum Central Development,
 Dundrum Road,
 Dublin 14**

Drawing Title:
Site Wide, Boundary Wall Survey Elevations 04

Job No.	Sheet Size	Scale @A1:
P19-233D	A1_Landscape	As indicated
Issue Date:	Drawn By:	Reviewed By:
Sept 2024	K. Potocka	R. Quinn

Status: **P3** Purpose of Issue: **Part 10 Planning Application**

Project - System - Spatial Zone - Level - Type - Originator - Role - Number	Revision
DCD-02-SW-ZZZ-DR-RAU-AR-2604	P3 S-1